

## Dimensions

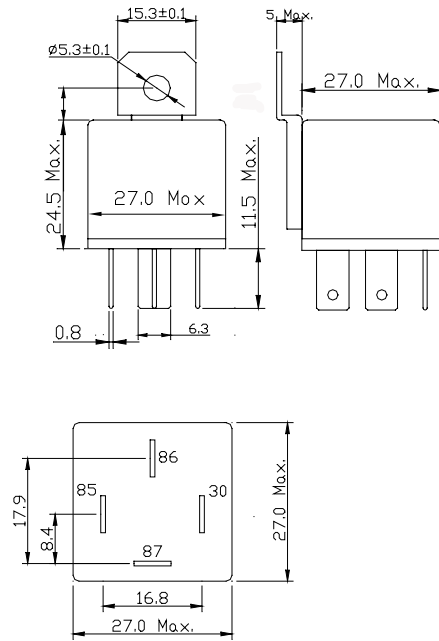

## Circuit Diagram

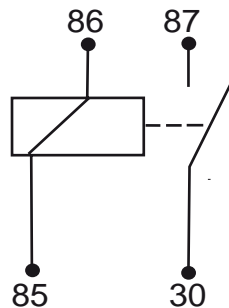

Nominal Coil Voltage: 24V  
 Rated Current: 67mA  
 Power Consumption: 1,6W  
 Coil Resistance: 360Ohm +/-10%  
 Switching Voltage: DC 75V  
 Feature: Bracket, Reversed Pinnig  
 Relays Type: Normally open  
 Contact Material: Silver Alloy  
 Nominal Current: 20A  
 Operation Life Electrical: 100,000  
 Temperature Range: -40°C...+85°C  
 Pulling Time: ~7ms  
 Drop Out Time: ~5ms  
 Operation Life Mechanical: > 10,000,000  
 Weight: 30g. approx.  
 Insulation Resistance: 100MOhm Min.(500V DC.)

				Date	Name	Mini Relays	Wittrin Electronic www.wittrin.com
			Author	30.10.06			
				Scale		Relais Schliesser, 24V, 20A Lasche, invertiertes Steckerbild	Part No.
							FRC1A-2REV24V
Index	Version	Date	Name				